

Proffer Surgical Center Addition Addendum 1

February 17th, 2018

Please allow the following identified on this three page document and three page attachment to serve as addendum one for the Proffer Surgical Center Addition Project.

Drawings:

- Sheet C-2 **Add** the following details – Attachments 1 through 3.
Attachment 1 / Detail 1 - “Concrete Pavement Sections”.
Attachment 2 / Detail 2 - “Drainage Channel Profile”.
Attachment 3 / Detail 3 – “Expansion Joint Profile”.
- Sheet C-2 **Add** the following General Note 1:
Review both C sheets and S sheets to fully comprehend extent of earthwork scope.
- Sheet C-3 **Substitute** the following for General note 4:
New pavement to match existing – density, reinforcement, depth and profile. Driveway pavement shall be 8” and parking stall pavement shall be 6”. See attachment 1, Detail 1 added to sheet C-2 – Concrete Pavement Sections.
- Sheet C-3 **Add** the following General note 5:
Review both C sheets and S sheets to fully comprehend extent of earthwork scope.
- Sheet C-3 **Add** the following sentences to Keyed note 8:
Contrasting integral color in concrete pour shall be a gray finish as per standard color options available. Submit to architect for review and approval.
- Sheet C-3 **Add** the following sentence to Keyed note 12:
Detail as per attachment 2 / detail 2, sheet C-2.
- Sheet C-3 **Add** the following sentences to Keyed note 16:
New sidewalk is 5” thick with 6” curb. Pavement is to slope away from building at 2% cross slope maximum.

C T B A S S O C I A T E S
A R C H I T E C T S • P L A N N E R S

- Sheet C-3 **Add** the following sentences to Keyed note 42:
Curb and gutter shall be poured monolithically. Profile is per attachment 1 / detail 1, sheet C-2.
- Sheet C-3 **Substitute** the following for Keyed note 44:
Planter at entry shall be integrally colored black finish. See detail for profile.
- Sheet S-1 **Add** the following sentence to Cast-In-Place Concrete note 1:
Spot footings and strip footings can be earth formed.
- Sheet A-1 **Add** the following sentence to Keyed note 20:
Cable shall be 1/4" or 3/16" stainless steel cable at 3" on center with Classic Button Turnbuckles as manufactured by Johnson Architectural Hardware.
- Sheet A-2 **Substitute** the following for General note 2:
Typical interior wall is 3 5/8" steel stud, 20 gauge, at 16" o.c. to 4" above ceiling with 5/8" gyp. bd. finish each side. See reflected ceiling plan for walls to structure.
- Sheet A-3 **Substitute** the following for General note 2:
Typical interior wall is 3 5/8" steel stud, 20 gauge, at 16" o.c. to 4" above ceiling with 5/8" gyp. bd. finish each side. See reflected ceiling plan for walls to structure.
- Sheet A-6 **Add** the following sentence to the bottom of General note 3:
Finished roof must have comparable product and finished look of existing roof system – the Hail Repair product identified above is part of the finished product and must be included in scope.
- Sheet A-8 **Add** the following General Notes:
3. Refer to structural drawings for profile and detail of all concrete slab and stem wall conditions.
4. 5/8" exterior grade plywood sheathing shall be substrate for all "Pac Clad" soffits.

Sheet A-9 **Add** the following General Notes:

5. Refer to structural drawings for profile and detail of all concrete slab and stem wall conditions.
6. 5/8" exterior grade plywood sheathing shall be substrate for all "Pac Clad" soffits.

Sheet A-14 **Substitute** the following for keyed note 9:

Kawneer aluminum "flush line" door, black anodized finish.

Sheet A-14 **Substitute** the following for keyed note 10:

Kawneer aluminum "flush line" transom, black anodized finish.

Sheet A-16 **Substitute** the following for CPT 2 in the Project Finish Schedule:

J & J Invision Fiction Modular 7025, Anti-Climax 1771, 24 x 24 modular carpet.

Specifications:

Section 3300 Cast-in-Place Concrete

2.5 A. 1. a. Fly Ash:

Substitute Class C for Class F specified.

Section 15325 Sprinkler Systems

2.1 A. 1. Type:

Substitute Chrome semi-recessed sprinkler heads – match existing type.

Section 15482 Medical Gas Systems

2.1 B.

Add Amico Corporation as an approved manufacturer for all products specified. All product must be minimally equal to product specified and must be reviewed and approved by engineer for incorporation into project.

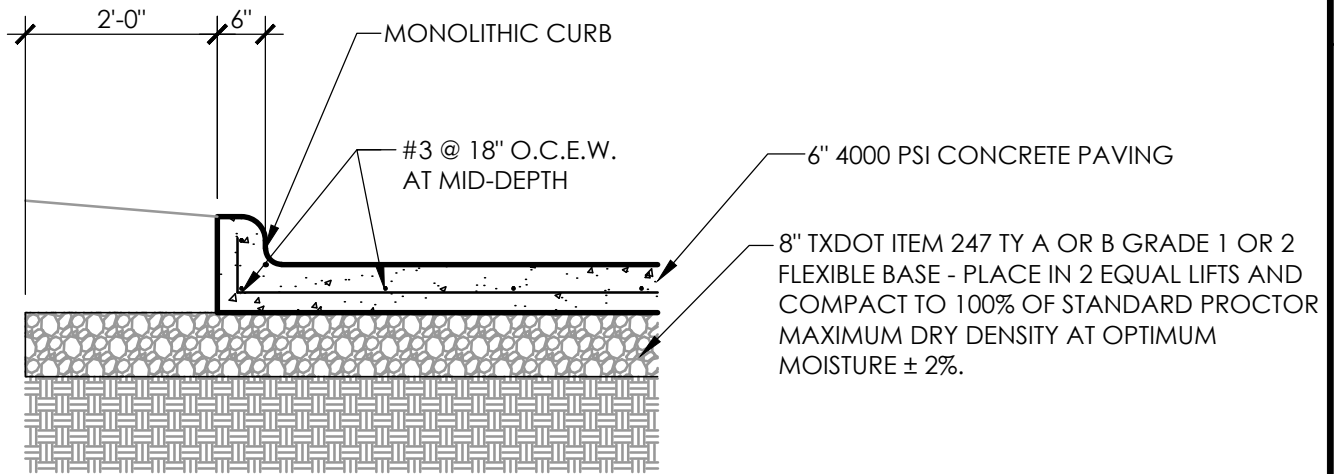

6" subgrade scarified and recompact to 100% of standard proctor dry density at optimum moisture content to + 4% of optimum. Determine PI of existing material. If PI is greater than 15, stabilize subgrade with hydrated lime or cement kiln dust (CKD). Amount of lime or CKD to reduce subgrade PI below 15 shall be determined by additional testing. All testing shall be performed by a professional engineer licensed in Texas. For bidding purposes assume 6% lime required for stabilization.

LIGHT DUTY CONCRETE PAVEMENT SECTION

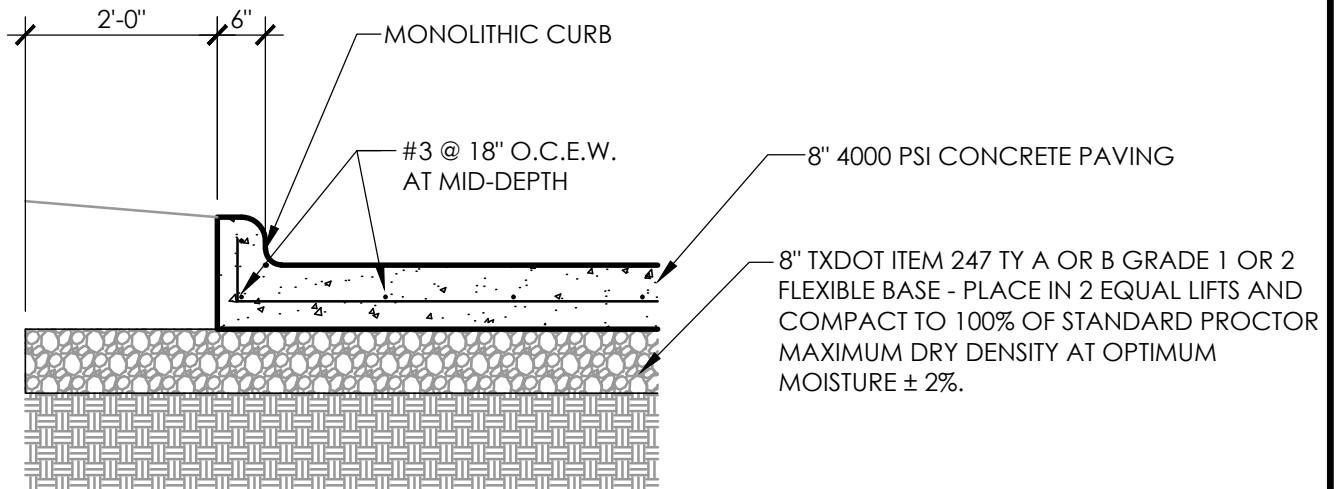

8" subgrade scarified and recompact to 100% of standard proctor dry density at optimum moisture content to + 4% of optimum. Determine PI of existing material. If PI is greater than 15, stabilize subgrade with hydrated lime or cement kiln dust (CKD). Amount of lime or CKD to reduce subgrade PI below 15 shall be determined by additional testing. All testing shall be performed by a professional engineer licensed in Texas. For bidding purposes assume 6% lime required for stabilization.

HEAVY DUTY CONCRETE PAVEMENT SECTION

CONCRETE PAVEMENT SECTIONS

1

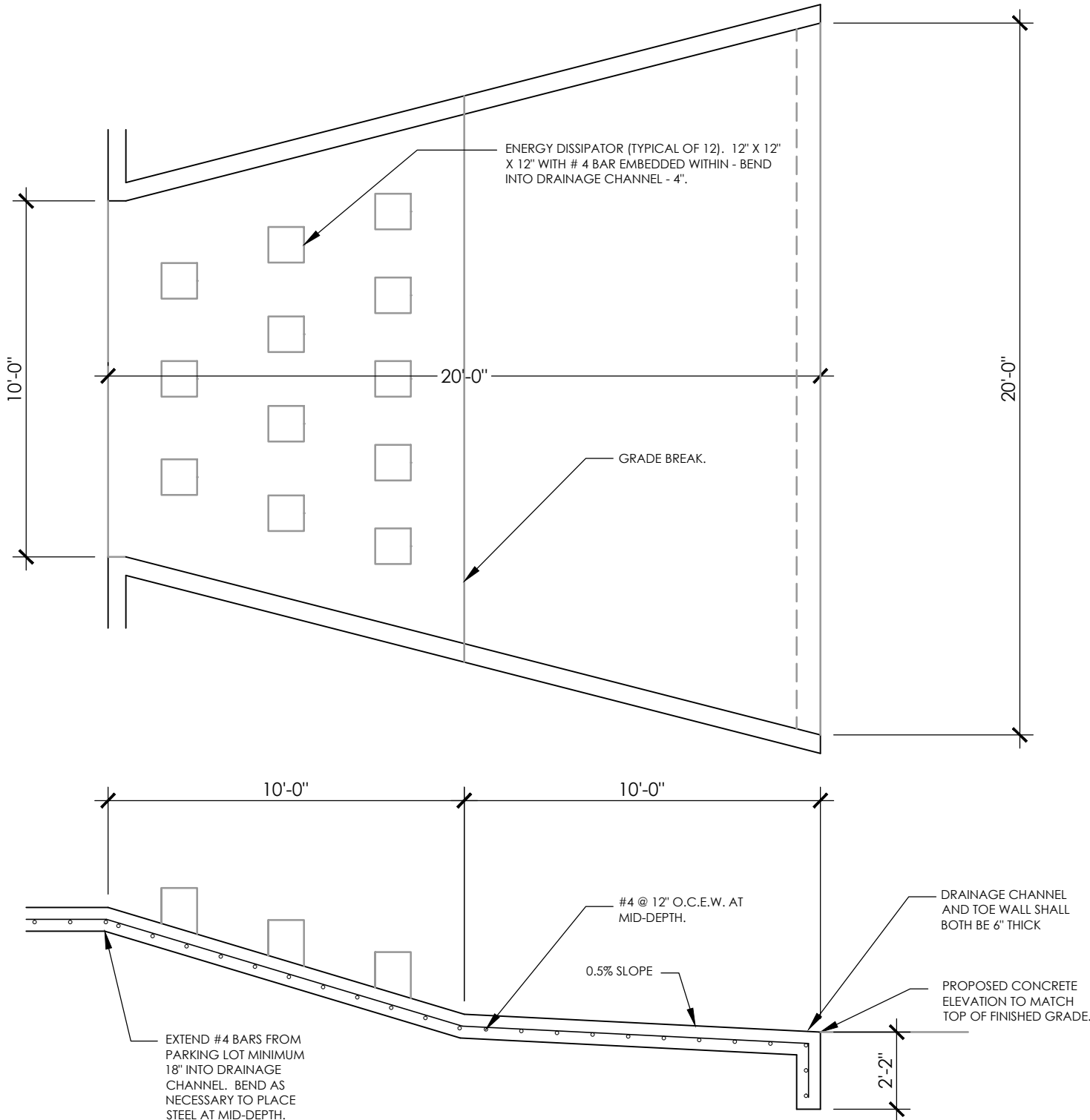

2

DRAINAGE CHANNEL PROFILE

ATTACHMENT 2 - ADDENDUM 1

SCALE: 1/4"=1'-0"

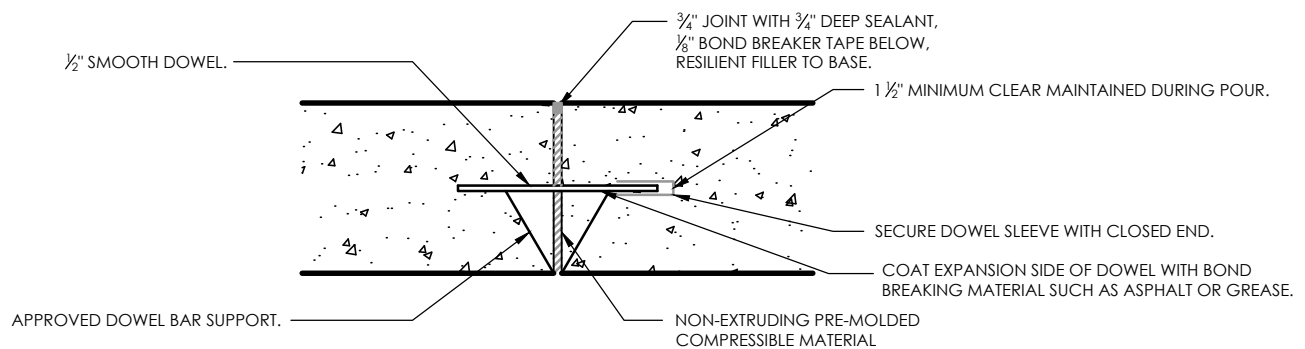

1. EXPANSION JOINT MATERIAL SHALL BE ACCURATELY NOTCHED OR HOLED TO RECEIVE EACH DOWEL.
2. DOWEL BARS SHALL BE ACCURATELY INSTALLED PARALLEL WITH PAVEMENT SURFACE. EACH DOWEL AND REBAR SHALL BE SECURED AGAINST DISPLACEMENT DURING CONCRETE POUR.
3. DOWELS SHALL BE CLEAN AND FREE OF RUST WHEN INSTALLED.
4. IN ALL AREAS WHERE NEW CONCRETE ABUTS EXISTING CONCRETE PAVEMENT, THE ABUTTING CONCRETE PAVEMENT SHALL BE SAW CUT FULL DEPTH.
5. DOWEL BARS SHALL BE INSTALLED AT 12" O.C. DOWEL BAR LENGTH SHALL BE 18" LONG.
6. EXPANSION JOINTS SHALL BE PLACED WHERE NEW CONCRETE PAVEMENT ABUTS EXISTING AND AT APPROXIMATELY 100' INTERVALS - CLOSEST JOINT SHOWN, VERIFY IN FIELD WITH LAYOUT.

3

EXPANSION JOINT PROFILE

ATTACHMENT 3 - ADDENDUM 1

NTS